

# INSTALLATION INSTRUCTIONS

## Series 400 / 470 Hinged Shower Enclosure

### SPECIFICATIONS:

**General:** All aluminum enclosures shall be series No. 400 as manufactured by Craft Fabricators, Ft. Scott, KS.

### MATERIALS AND CONSTRUCTION:

Aluminum extrusions to be of 6463 T-5 alloy. All screws to be stainless steel.

### FINISH:

Silver - Polished Bright Dip Anodized.  
Gold - Polished Bright Dip Gold Anodized.

To install your shower enclosure, you will need the following:

- level
- 1/8", 1/4" and 9/64" drill bits
- phillips screwdriver
- sealant

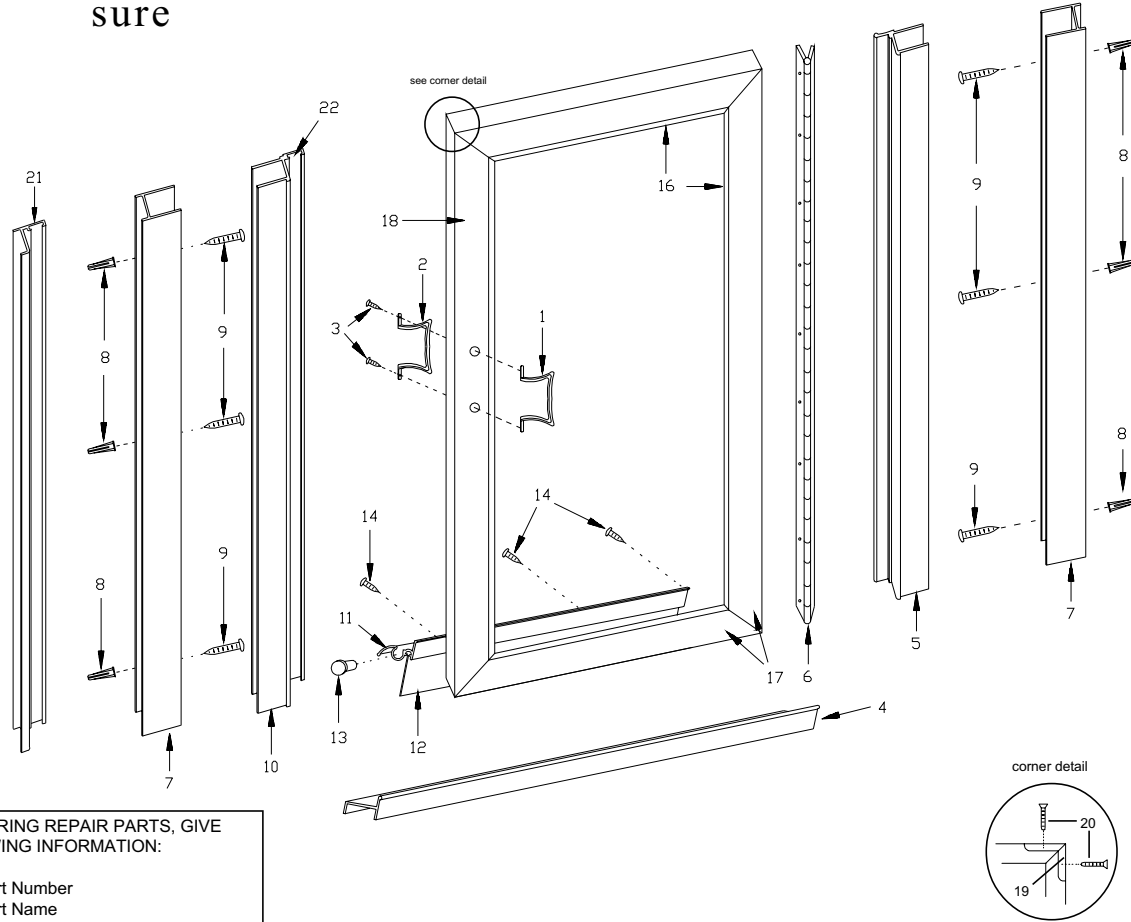

DESCRIPTION	QTY.	PART #	
1. Outside (male) door handle	1	VPC-125	
2. Inside (female) door handle	1	VPC-125	
3. #6-32 x 5/8" flat head machine screws	2		
4. Threshold	1	CFM-70	
5. Expansion hinge jamb	1	CFM-4	
6. Hinge	1		
7. Wall channels	2	CFM-53	
8. Wall anchors	6		
9. #8 x 1 1/2" truss head sheet metal screws	6		
10. Expansion strike jamb	1	CFM-54	
11. Drip channel	1	CFM-49	
12. Drip channel vinyl	1	900	
13. Drip channel plug	1	62M9012	
14. #6 x 3/8" pan head sheet metal screws	9		
15. Tempered glass (glass units)	1	998	
16. Glazing vinyl	16 ft.	919	
17. Glass frame	3	CFM-1	
18. Magnetic glass frame	1	CFM-83	
19. Corner angles	4	193-1-1	
20. #8-32 x 1/2" flat head machine screws	8	301	
21. Standard strike jamb (for door with one adjustable jamb)	1	CFM-84	
22. Magnetic strip	2	M-225	

WHEN ORDERING REPAIR PARTS, GIVE THE FOLLOWING INFORMATION:

1. Part Number
2. Part Name
3. Model Number
4. Specify design, if any

## Step 1

SERIES 400 / 470

### Assemble door handles

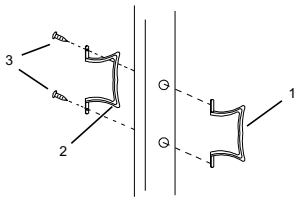

- attach outside (male) door handle (1) and inside (female) door handle (2) to door with two #6-32 x 5/8" flat head machine screws (3).
- set door assembly aside. (The inside door handle should be placed on the magnet side of the door.)

## Step 2

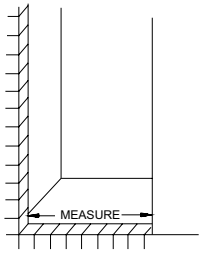

- this door is reversible and can swing to the right or left. (A right-swung door is shown.) Decide which way you wish your door to swing.
  - measure the wall to wall opening of the shower curb.
  - cut bottom threshold (4) 1/16" less than opening width.
- Note:** Make sure high side of threshold is to the outside of shower.

## Step 3

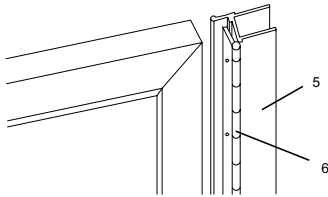

- after door swing has been determined, cut adjustable hinge jamb (5) and wall channel (7) flush with top of door

## Step 4

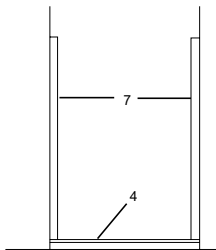

- position wall channels (7) on threshold (4), making sure threshold is centered on curb.
- plumb wall channels (7) and mark installation holes on wall.
- remove all parts
- for ceramic tile installation, use a 3/16" masonry bit for drilling installation holes.
- install plastic wall anchors (8).
- for fiberglass installation, use a 1/8" drill bit for drilling installation holes.

## Step 5

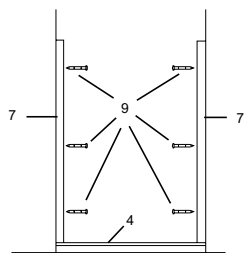

- replace wall channels (7) in previous location.
- secure wall channels to wall with six #8 x 1 1/2" truss head sheet metal screws (9).

## Step 6

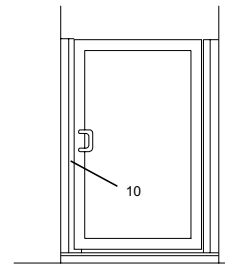

- place adjustable strike jamb (10) into wall channel (if this option is ordered) or standard jamb (21) against wall.
- close door against strike jamb making sure door is flush against jamb.

## Step 7

### Units with standard jambs

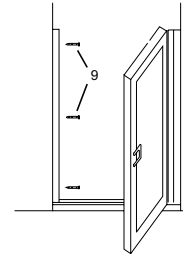

- plumb standard strike jamb (21).
- mark holes on wall (units with standard jamb).
- remove strike jamb.
- using a 3/16" masonry bit, drill installation holes and install plastic wall anchors (8).
- replace strike jamb (21), secure to wall with three #8 x 1 1/2" truss head sheet metal screws (8).

## Step 8

### Units with adjustable jambs

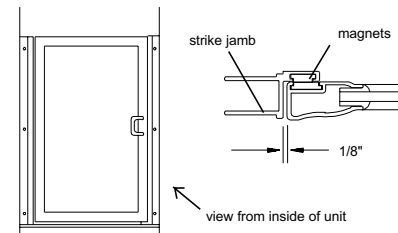

- adjust unit to opening.
  - drill 3/32" holes in back of adjustable strike jamb (10) and hinge jamb (5).
  - secure using six #6 x 3/8" pan head sheet metal screws (14).
- NOTE:** If magnet does not pull door shut, reverse strike jamb magnet. Groove in magnets should match.

## Step 9

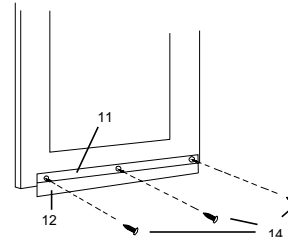

- cut drip channel (12) 1/4" less than panel width.
  - notch drip channel 3/4" at hinge side to allow channel to overlap hinge jamb.
  - using a file, round off both lower corners of drip channel.
  - insert drip channel vinyl (13) into drip channel (12) and trim to size.
  - insert plastic drip channel plug (14) into end of drip channel.
  - with door closed, position drip channel on inside of door with a slope to the hinge side.
  - mark the location, then clean door thoroughly with rubbing alcohol.
  - peel protective cover off double face tape and install drip channel.
  - for additional security, drill three 3/32" holes from drip channel into door.
  - secure with three #6 x 3/8" pan head machine screws (15).
- IMPORTANT:** holes must be drilled a minimum of 3/8" below exposed glass.

## Step 10

- seal with silicone the inside and outside of the unit at any point unit meets wall or curb.